

Product specifications



- Sample: duodenal biopsy specimen
- Test principle: detection of lactase activity
- Test components: test plate, reagent bottles (3 pcs), instruction for use
- Storage: 2-8 °C



Not available in the United States. In Japan for research use only. Check availability for other markets.

Reference

1. Jolanda F, Parodi F et al. Poster presentation at DDW 2009; S2067.
2. Kuokkanen M, Myllyniemi M et al. Endoscopy 2006; 38: 708-712.
3. Ojetti V, La Mura R et al. Dig Dis Sci. 2008; 53(6): 1589-92

BIOHIT Lactose Intolerance quick test



Ordering details:

REF	Product
602010	Lactose Intolerance quick test, 25 tests
602012	Lactose Intolerance quick test, 10 tests
602018	BIOHIT Lactase Control

CONTACT

Biohit Oyj
Laippatie 1
00880 Helsinki
Finland
Tel. +358 9 773 861
info@biohit.fi

Biohit HealthCare Srl
Via Boncompagni, 3
20139 Milano
Italy
Tel +39 02 38238113
Fax +39 02 38236521
info.italy@biohit.fi

Biohit HealthCare Ltd.
Pioneer House, North Rd
Ellesmere Port, CH65 1AD,
United Kingdom
Tel. +44 151 550 4 550
Fax. +44 151 550 4 551
info@biohithealthcare.co.uk

biohithealthcare.com

BIOHIT
Innovating for Health

BIOHIT Lactose Intolerance quick test



RAPID RESULTS DURING GASTROSCOPY



490061en-04 © BIOHIT OYJ 08/2023

BIOHIT
Innovating for Health

BIOHIT Lactose Intolerance quick test

Confirmed results during gastroscopy

The Lactose Intolerance quick test detects all types of lactase deficiency from biopsy specimens. This gives added value to gastroscopies with minimum effort. The test is based on the normal lactase enzyme reaction and is therefore able to detect lactase deficiency as well as indicate the functionality of the enzyme. The lactose intolerance quick test is not only a sensitive diagnostic tool, but it has also been found to be more accurate than lactose breath test in predicting clinical response to lactose-free diet.

- Results in 20 minutes
- Simple color chart interpretation
- All reagents ready-to-use
- Sensitivity 95 %, specificity 100 %²
- Superior sensitivity compared to lactose breath test³

Easy testing from a duodenal biopsy specimen

The test procedure of the Lactose Intolerance quick test is fast and simple. The biopsy specimen is placed in the test plate and test reagents are added on the sample. Clear color change indicates the test result within 20 minutes enabling testing and reporting during one visit.

Simple test procedure

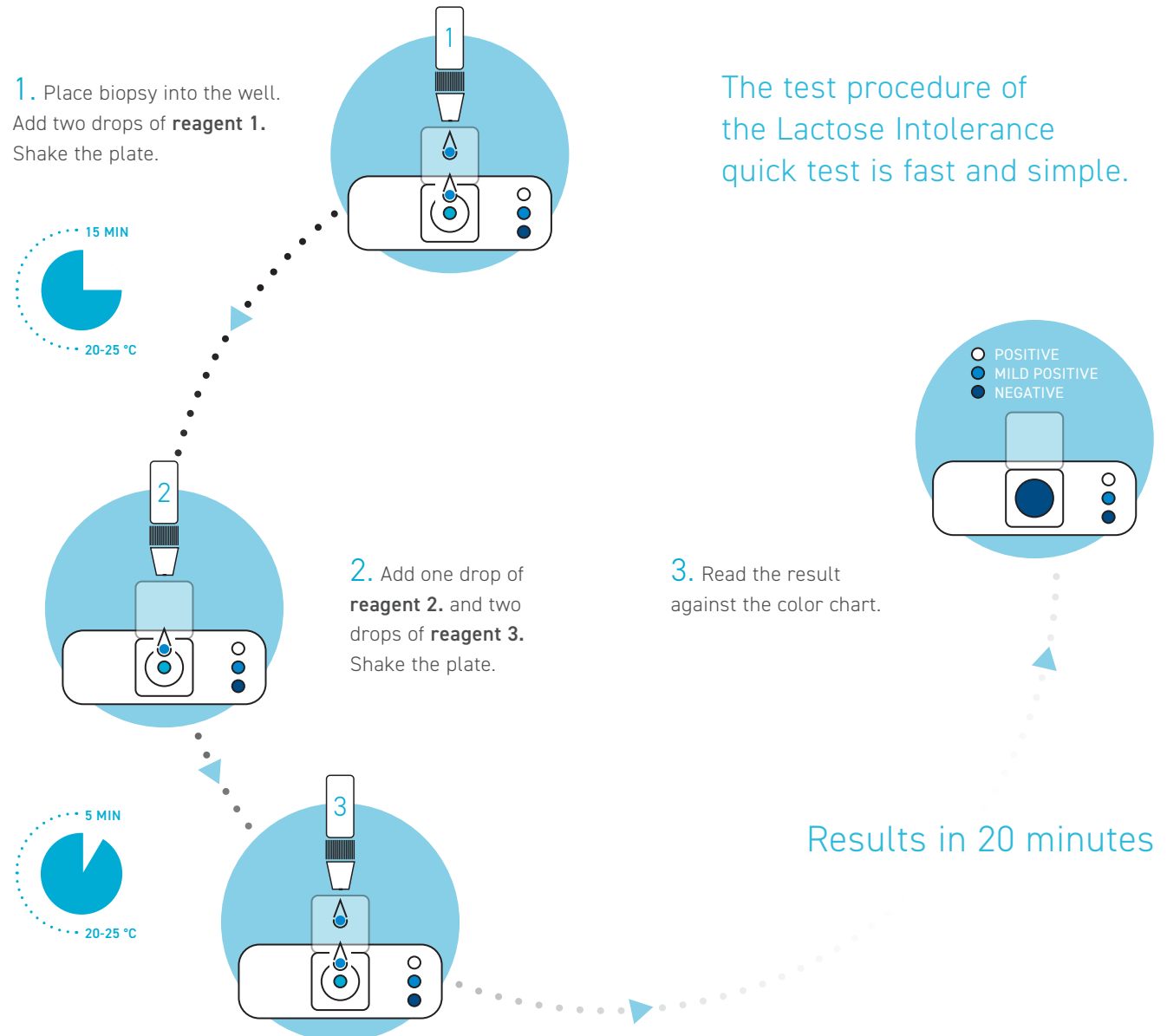

The test procedure of the Lactose Intolerance quick test is fast and simple.